



A new closer
creation for
enhanced
architectural
elegance.

DORMA TS 97





Innovative architectural concepts offer form and function combined.

Contemporary architecture is characterised by distinctive design lines that accommodate the desire for aesthetic elegance as an integral element within a well functioning whole. Harmony of appearance needs to be maintained throughout. And this is precisely the design brief to which DORMA has

developed the TS 97. Our new door closer has been specifically designed to match perfectly the optical opulence of high-quality project doors while at the same time offering maximum functional convenience. The DORMA TS 97 – an impressive synthesis of form and function.



A decorative graphic consisting of a white square partially overlapping a dark blue square.

DORMA TS 97. Functional component, fascinating aesthetics.

With the TS 97, DORMA has opened up a new segment in the premium class of door closers.

Its high technological quality is matched in full by its impressive design credentials. The straight lines of its cubic form exude elegant compactness. And – as a characteristic feature of this particular system – the closer body and slide channel are of identical length.

The single piece faceplate has no slots or fixing points and even the end caps are flush. All the clearance and gap dimensions have been reduced to a minimum. With a wide range of surface finishes available, the TS 97 can be ideally adapted to any décor. All in all, it offers a solution that can satisfy all the requirements embodied in a high-quality architectural project.





Closer body and slide channel of identical lengths.

Distinctive design lines, coincidence of contours.

As a surface mounted door closer of consummate compactness, the DORMA TS 97 offers a clearly defined profile suited to a wide range of application requirements. The body is just 37 mm deep, while the slide channel is perfectly aligned to its small width. It is also

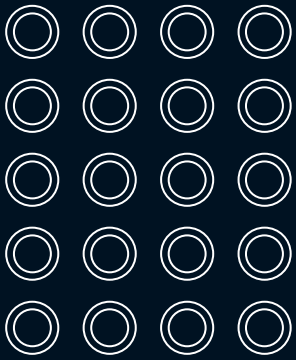
vertically adjustable. This enables the overall appearance to be further optimised and ideally adjusted to the door and frame arrangement. There is a wide range of surface finishes available to enable full integration within discrete architectural concepts.



Two small squares, one white and one dark blue, are positioned to the left of the main text.

Reduced to the essential. The smallest surface-mounted cam action door closer in the project sector.

A grey rectangular box containing the text "37 mm" in a large, white, sans-serif font. A thin red horizontal line is located below the box.

**37
mm**

With its compact design and an overall depth of just 37 mm, the DORMA TS 97 has opened up a new dimension in the market for surface-mounted door closers. Ideally sized, it provides for a solution of exemplary elegance. Even when viewed from the side, the TS 97 offers unimpaired visual charm. Through its discreet overall appearance, such a closer enhances the overall architectural effect of the door and its surroundings.



■ A perfect combination of high-grade finish
and smart technology

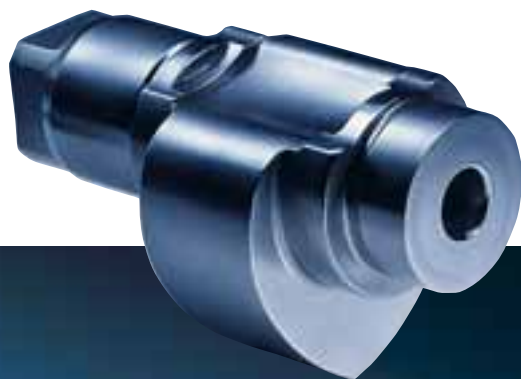

The heart-shaped cam ensures maximum ease of use through minimised opening effort.

The technology is such that opening resistance is immediately reduced as the door comes. Door operation is thus literally child's play.

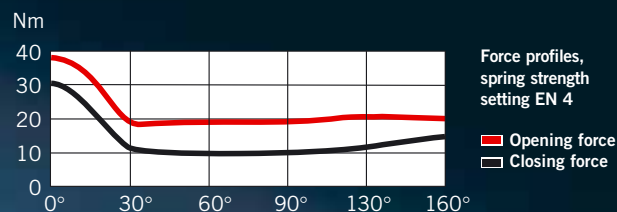

Anodised surface finishes that exude exclusivity.

The truly salient feature of the DORMA TS 97 is its beautifully shaped design. The high-quality appearance of the closer is further enhanced by a wide range of

finishes that can be selected to suit the surroundings and project specifications. A particularly prestigious effect can be achieved with our anodised aluminium finish and the "Design" range: "stainless steel" or

"polished brass". White is also available as a standard colour, as are various special colours. The architect thus has a wide optical spectrum to choose from in the creation of contemporary door designs.

Architectural solutions – uncomplicated sophistication achieved with ease.



The DORMA TS 97 can be mounted with ease either to the door leaf or the frame. Its hydraulic functions are adjustable from the top face, while closing force adjustment is performed from the side. The TS 97 is compliant with EN 1154 and carries the **CE** mark.

approx. 120°

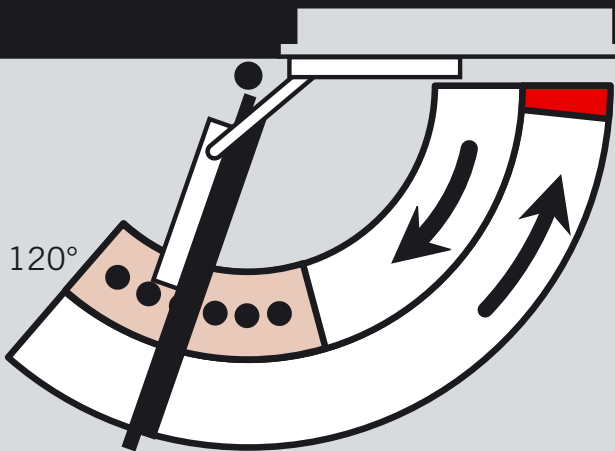

Cushioned limit stay.

The cushioned limit stay integrated in the standard slide channel assembly helps to prevent a normally opened door from colliding with the adjacent wall. It can be adjusted to an opening angle between approx. 80° and max. 120°.

RF mechanical hold-open unit.

A hold-open unit is also available as an optional extra.

approx. 120°

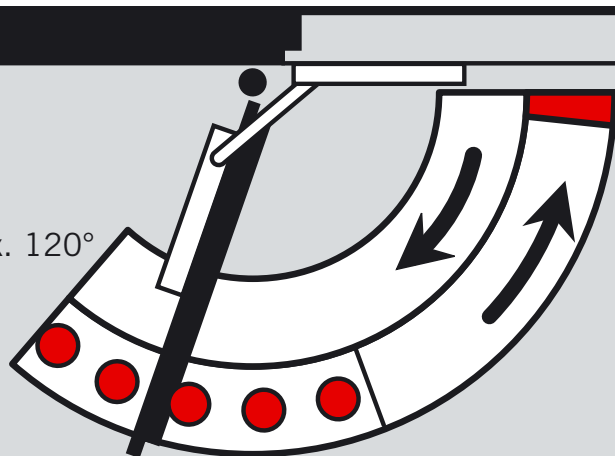

Vertical adjustment of the slide channel.

The slide channel is vertically adjustable to ensure perfect adaptability to the door-and-frame arrangement.

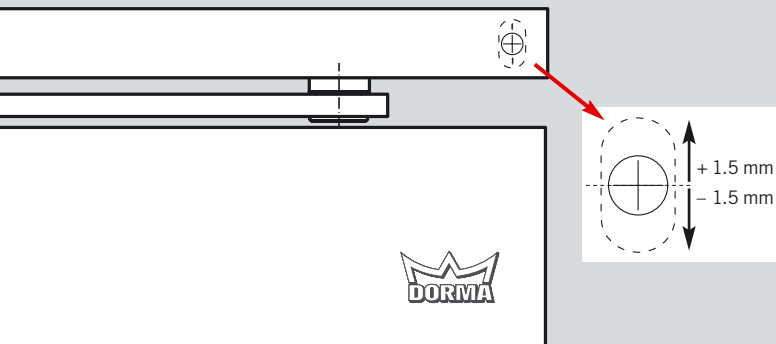

DORMA TS 97 – equipped with superior technology as standard.

Aside from a rapidly decreasing opening torque for effortless opening of the door, the new closer also offers all the advantages of closing force adjustability and a latching action variability that ensures secure closing every time. The closing force, adjustable between EN 2 and EN 4, opens up a wide range of applications up to maximum door widths of 1100 mm. The closer complies with EN 1154 and carries the **CE** mark. It is also manufactured with quality assurance to ISO 9001. So it satisfies every conceivable requirement.

Data and features		TS 97
Closing force	Spring strength	EN 2-4
Standard doors	1100 mm	●
External doors, outward opening		–
Fire and smoke check doors		●
Non-handed		●
Vertically adjustable slide channel		●
Closing speed adjustment by valve variable		●
Latching action adjustment by valve variable		●
Cushioned limit stay (mechanical)		●
Delayed action		–
Backcheck		–
Hold-open		○
Weight in kg		2,5
Dimensions in mm	Length	340
	Overall depth	37
	Height	49
Door closer compliant with EN 1154		●
CE mark for construction products		●
● Yes – No ○ Option		

Частное торгово–производственное унитарное предприятие
«Новые электросистемы»

220024 г. Минск, пер. Корженевского, д. 2а, офис 14

(017) 228–00–00

(017) 207–54–44

(017) 212–77–19

E-mail: info@electrosystem.by

Сайт: www.electrosystem.by